

## Chapter 06: Reinforced Mesh, Mortar Profiles, EIFS Plugs



**Mesh**



**Protective Strips**



**Beads for Interior Plasters**



**Beads for Exterior Plasters**



**Widra and Laths**



**Profiles for EIF-Systems**



**Beads for Dry Construction Builders**



**Profile Fixings, Connectors and Spacer Tubes**



**Plugs**

## Mesh

### Plaster mesh



#### Interior plaster mesh

The economical mesh for interior plaster, alkali-resistant and non-slip. tensile strength longitudinal / transverse approx. 100/105, mesh size 5x5mm, weight approx. 75g/m2.

Itm.Nr.	Description	Unit
750	Interior plaster mesh 750 100m2/roll weight 75g/m2 mesh size 5x5mm 115	Roll

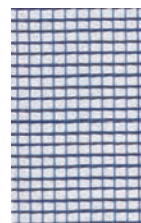

#### Plaster mesh

The economic reinforced mesh for interiors and exteriors, tensile strength longitudinal /transverse approx. 185/220, mesh size 13x13mm, weight approx. 135g/m2.

Itm.Nr.	Description	Unit
1251	Exterior plaster mesh 1250 50m2/roll. weight 135g/m2 mesh size 13x13mm 121/8	Roll
1250	Exterior plaster mesh 1250 100m2/roll. weight 135g/m2 mesh size 13x13mm 121/8	Roll

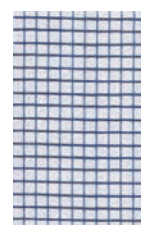

#### Universal plastering mesh for interiors

The reinforced mesh for interior plaster, highly alkali-resistant and non-slip. tensile strength longitudinal / transverse approx. 160/150, mesh size 7x7mm, weight approx. 105g/m2.

Itm.Nr.	Description	Unit
121	Universal plastering mesh 121 100m2/roll. weight 105g/m2 mesh size 7x7mm	Roll



#### Universal plastering mesh

The reinforced mesh for interiors and exteriors, tensile strength longitudinal /transverse approx. 200/225, mesh size 8x7mm, weight approx. 165g/m2.

Itm.Nr.	Description	Unit
15000	Universal plastering mesh 1500 50m2/roll. weight 165g/m2 mesh size 8x7mm 123S300	Roll



#### Plastering mesh

For difficult applications, e.g. in architraves, tensile force longitudinal / transverse 210/290, mesh size 7x7mm.

Itm.Nr.	Description	Unit
3500	Universal plastering mesh 3500 50m2/roll weight 210g/m2 mesh size 7x7mm	Roll

### EIFS-mesh

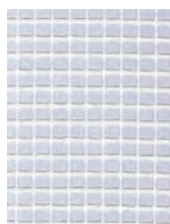

#### EIFS-mesh

The reinforcement mesh for EPS exterior insulating finishing system, inspection report by MA 39 (Testing and Research Institute), mesh size 4 x 4 mm.

Itm.Nr.	Description	Unit
3000	Exterior insulating finishing system mesh 3000 50m2/roll mesh size 4x4mm checked in accordance with ETAG 004/2000	Roll
3000OR	Exterior insulating finishing system mesh 3000 orange 50m2/roll, mesh size 4x4mm MA39 approved 122	Roll
3000T	Exterior insulating finishing system mesh 50m2/roll, mesh size 4x4mm checked in accordance with ETAG	Roll
3000LO	Exterior insulating finishing system mesh Lorencic System 50m2/roll, mesh size 4x4mm checked in accordance with ETAG	Roll

## Reinforced Mesh, Mortar Profiles, EIFS Plugs



### EIFS-system mesh, cork

Reinforced mesh for cork facing boards, tensile strength longitudinal / transverse approx. 200/225, mesh size 7x7mm, weight approx. 200g/m2.

Itm.Nr.	Description	Unit
123	Full thermal insulation mesh, cork 123 50m2/roll weight 200g/m2 mesh 7x7mm PU20	Roll

## Reinforced mesh darts



### Reinforcement mesh arrow

Vastly prevents the diagonal formation of cracks in the corners of windows and doorways, reinforcements for EIFS and other plaster systems, size 380x330mm, 90° angle.

Itm.Nr.	Description	Unit
5004043	Reinforcement mesh arrow 380x330mm 8x8mm 90° Packaging unit100	BOX
5004044	Reinforcement mesh arrow 380x330mm 4x4mm 90° Packaging unit100	BOX

## Protective Strips

### Protective Strips "Plaster"

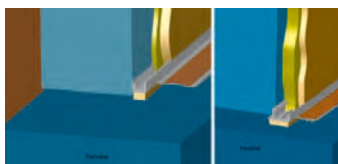

### Protective strips

Self-adhesive plastic profiles are fitted out with sealing tape, which is impermeable to air and driving rain, and a bridge with self-adhesive tape for the application of a protective film for windows and doors. Minimum processing temperature +5°C. Maximum profile length 240cm.

Itm.Nr.	Description	Unit
6430105	Protective strips, narrow 6x6mm 1.40 running metres Packaging unit30	RAIL
6430205	Protective strips, narrow 6x6mm 2.40 running metres Packaging unit30	RAIL
314	Protective strips, width 8x8mm 1.40 running metres Packaging unit30	RAIL
324	Protective strips, narrow 8x8mm 2.40 running metres Packaging unit30	RAIL
114	Protective strips, width 8x15mm 1.40 running metres Packaging unit30	RAIL
124	Protective strips, width 8x15mm 2.40 running metres Packaging unit30	RAIL



### Flexible protective strips without sealing lip

Release of the otherwise rigid removable strip is no longer necessary, additional gluing of fittings is no longer necessary, optimum protection of fixings. Flexible without sealing lip. 9mm wide, 3mm foam tape, this is to protect against UV-radiation on-site. Minimum processing temperature +5°C. T-FAL-profiles are usually suitable for three-dimensional movement up to 3 mm and profile lengths of up to 300 cm. Please pay attention to the manufacturer's instructions.

Itm.Nr.	Description	Unit
3717140	Protective strip, flexible without sealing lips 1.40running metres Packaging unit60	RAIL
3717250	Protective strip, flexible without sealing lips 2.50running metres Packaging unit60	RAIL



### Flexible protective strips with sealing lip

The elastic sealing lip prevents direct or indirect radiation on the foam tape. Transition from plaster to window or door is therefore designed to be seamless. This flexible strip wraps around the fittings making it no longer necessary to cut the strip. Flexible with sealing lips 10mm wide, 3mm foam tape. Minimum processing temperature +5°C. T-FAL-profiles are usually suitable for three-dimensional movement up to 3 mm and profile lengths of up to 300 cm. Please pay attention to the manufacturer's instructions.

Itm.Nr.	Description	Unit
3795140	Protective strip, flexible with sealing lip, 1.40running metres/rail Packaging unit60	RAIL
3795250	Protective strip, flexible with sealing lip, 2.50running metres/rail Packaging unit60	RAIL



### Reveal bead with sealing lip

Self-adhesive PVC profile for connections to frames with sealing lip for the creation of a technical and proper visual solution. Minimum processing temperature +5°C. Maximum processing length 260cm due to potential length expansion.

Itm.Nr.	Description	Unit
43712150	Reveal bead 3712 interior plaster PVC with sealing lips 1.50running metres/rail Packaging unit60	RAIL
43712260	Reveal bead 3712 interior plaster PVC with sealing lips 2.60running metres/rail Packaging unit60	RAIL

## Reinforced Mesh, Mortar Profiles, EIFS Plugs



### Reveal bead with sealing lip and movement joints

Profile for connections to frames with sealing lip for the creation of a technical and proper visual solution. Minimum processing temperature +5°C. Maximum processing length 260cm due to potential length expansion.

Itm.Nr.	Description	Unit
43726150	Reveal bead 3726 interior plaster with sealing lips and movement joints 1.50 running metres Packaging unit50	RAIL
43726260	Reveal bead 3726 interior plaster with sealing lip and movement joints 2.60 running metres Packaging unit50	RAIL



### Protective Strips, RAL-tested, for interiors

This sealing profile for interiors has a flexible removable strip. This flexible strip wraps around the fittings making it no longer necessary to cut the strip. According to the "Guide for Assembling Windows and Doors in Houses" laid down by the RAL-Quality Association, this layer is to be airtight and more vapour diffusion-tight than the external layer and is designed to be permanent. sD-value > 100m. 10mm wide, 3mm foam tape, minimum processing temperature +5°C. T-FAL-profiles are usually suitable for three-dimensional movement up to 3 mm and profile lengths of up to 300 cm. Please pay attention to the manufacturer's instructions.

Itm.Nr.	Description	Unit
3765250	Protective strip RAL interior, red, flexible with lip, 2.50running metres Packaging unit60	RAIL



### Protective Strips, RAL-tested, for exteriors

The elastic sealing lip creates the visual appearance of an elastic caulking joint, therefore no sealing with elastic caulking sealant is necessary. The lip also protects the foam tape from dirt and UV-radiation. According to the "Guide for Assembling Windows and Doors in Houses" laid down by the RAL-Quality Association, this layer is to be windtight and more vapour diffusion-open than the internal layer and is designed to be permanent. sD-value < 25m, 10mm wide, 3mm foam tape. Minimum processing temperature +5°C. T-FAL-profiles are usually suitable for three-dimensional movement up to 3 mm and profile lengths of up to 300 cm. Please pay attention to the manufacturer's instructions.

Itm.Nr.	Description	Unit
3775250	Protective strip RAL exterior, green, flexible with lip, 2.50running metres Packaging unit60	RAIL

## Protective Strips with EIFS-mesh

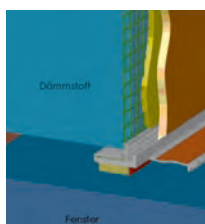

### Flexible protective strips with EIFS mesh

The profile is equipped with reinforced mesh, as well as sealing tape, which is impermeable to air and driving rain. With EIFS mesh. Minimum processing temperature +5°C. Maximum profile length 240mm.

Itm.Nr.	Description	Unit
514	Protective strip with full thermal insulation mesh 1.40running metres Packaging unit25	RAIL
524	Protective strip with full thermal insulation mesh 2.40running metres Packaging unit25	RAIL
6470105001	Protective strips PVC, 6 mm with mesh 1.4m per rail Packaging unit30	RAIL
6470205	Protective strips PVC, 6 mm with mesh 2.4m per rail Packaging unit30	RAIL



### Flexible protective strips with EIFS mesh and sealing lip

Clean connection, simple processing, with EIFS mesh and sealing lip. The elastic sealing lip prevents direct or indirect radiation on the foam tape. 10mm wide, 3mm foam tape. Additional beading is no longer necessary! Minimum processing temperature +5°C. T-FAL-profiles are usually suitable for three-dimensional movement up to 3 mm and profile lengths of up to 300 cm. Please pay attention to the manufacturer's instructions.

Itm.Nr.	Description	Unit
3798140	Protective strip, flexible with mesh and sealing lip, 1.40running metres Packaging unit60	RAIL
3798250	Protective strip, flexible with mesh and sealing lip, 2.50running metres Packaging unit60	RAIL

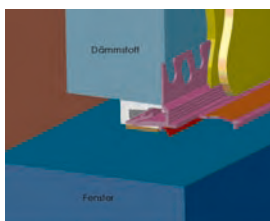

### Window connector section Praktika

Bead for connecting windows with a sealing. Bead is inserted between insulation material and window or door frame after the insulation has been fitted. On inserting the bead the key is pressed together and the sealing prestressed. This leads to the bead anchoring between the insulation and frame.

Itm.Nr.	Description	Unit
32514	Window connection profile Praktika, 1.40 running metres Packaging unit30	RAIL
32524	Window connector section Praktika, 2.40 running metres Packaging unit30	RAIL

## Reinforced Mesh, Mortar Profiles, EIFS Plugs

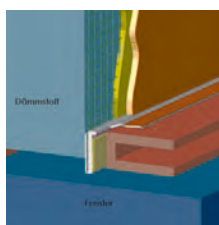

### Protective strips for roller blind rail with EIFS mesh

Clean connection, maintenance-free joint, simple processing, with EIFS mesh.

Itm.Nr.	Description	Unit
714	Protective strip with mesh 1.40running metres for roller shutter runner Packaging unit25	RAIL
724	Protective strip with mesh 2.40running metres for roller shutter runner Packaging unit25	RAIL

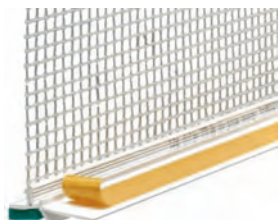

### Protective strips RAL, EIFS

The elastic sealing lip creates the visual appearance of an elastic caulking joint, therefore no sealing with elastic caulking sealant is necessary. According to the "Guide for Assembling Windows and Doors in Houses" laid down by the RAL-Quality Association, this layer is to be windtight and more vapour diffusion-open than the internal layer and is designed to be permanent.

Itm.Nr.	Description	Unit
3778250	Protective strip RAL exterior, green, flexible with mesh and lip, 2.50running metres Packaging unit60	RAIL

## Protective Strips - Equipment



### Pressure roll

Equal pressure on the profiles, optimum and simple handling right up to the corners, for left and right handers.

Itm.Nr.	Description	Unit
3704	Pressure roll T-FAL	Item



### Bonding enhancer 3-fix

Perfect adhesion of profiles to plastic, aluminium and wooden elements due to cleaning effect, bio-degradable.

Itm.Nr.	Description	Unit
3706	Bonding enhancer 3-fix for T-FAL profiles for connections to frames	Item



### Shears T-FAL

Clear cut, exact cutting on mitre using scale and fixture angle.

Itm.Nr.	Description	Unit
3709	Heavy shears T-FAL for protective strips	Item
Z28805	Replacement blade for T-FAL shears 37091 Packaging unit10	Pg.



### Parapet band, 3-line

For creating a connection, which is permanently airtight inside and vapour diffusion-tight towards the outside in the parapet or floor area in order to separate indoor and outdoor climates. Airtight in accordance with DIN 4108 EnEV § 5 (1), sD-value > 100m, aluminium metallised, with one-sided adhesive tape for fixing to window or door elements. Bond to parapet with adhesive bonding compound 3-grip (item no. 3752).

Itm.Nr.	Description	Unit
3751	Parapet band, 3-line 25running metres / roll Packaging unit3	Item



### Adhesive bonding compound, 3-grip

This bonding compound is a hybrid-based sealant. Extremely high UV and aging resistant as well as excellent adhesion to easily absorbent surfaces (dry/ slightly damp). Colour: white.

Itm.Nr.	Description	Unit
3752	Adhesive bonding compound, 3-grip	Item

## Beads for Interior Plasters

### Angle Beads

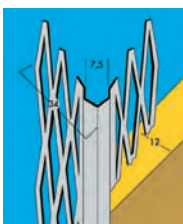

#### Angle bead

Sharp-edged mortar profile, no nails required, fast and easy mounting.

Itm.Nr.	Description	Unit
4015	Angle bead, KÅ5 1.50running metres/rail 1batch=37.50running metres Packaging unit25	BATCH
4016	Angle bead, KÅ5 1.60running metres/rail 1batch=40.00running metres Packaging unit25	BATCH
4018	Angle bead, KÅ5 1.80running metres/rail 1batch=45.00running metres Packaging unit25	BATCH
402	Angle bead, KÅ5 2.00running metres/rail 1batch=50.00running metres Packaging unit25	BATCH
4022	Angle bead, KÅ5 2.20running metres/rail 1batch=55.00running metres Packaging unit25	BATCH
40225	Angle bead, KÅ5 2.25running metres/rail 1batch=56.25running metres Packaging unit25	BATCH
4025	Angle bead, KÅ5 2.50running metres/rail 1batch=62.50running metres Packaging unit25	BATCH
4026	Angle bead, KÅ5 2.60running metres/rail 1batch=65.00running metres Packaging unit25	BATCH
4027	Angle bead, KÅ5 2.70running metres/rail 1batch=67.50running metres Packaging unit25	BATCH
40275	Angle bead, KÅ5 2.75running metres/rail 1batch=68.75running metres Packaging unit25	BATCH
4028	Angle bead, KÅ5 2.80running metres/rail 1batch=70.00running metres Packaging unit25	BATCH
403	Angle bead, KÅ5 3.00running metres/rail 1batch=75.00running metres Packaging unit25	BATCH
4035	Angle bead, KÅ5 3.50running metres/rail 1batch=87.50running metres Packaging unit25	BATCH

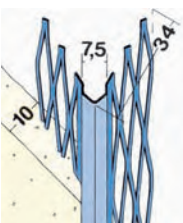

#### Corner bead 1007 Protektor

Angle profile with raised zinc coat for more safety. Ever shorter construction times have resulted in profiles being developed that can ride out longer exposure to moisture without being damaged. The profile is manufactured with larger draw panels. This guarantees optimum plaster penetration.

Itm.Nr.	Description	Unit
4100715	Corner bead 1007 1.50running metres/rail 1batch=37.50running metres Packaging unit25	BATCH
4100716	Corner bead 1007 1.60running metres/rail 1batch=40.00running metres Packaging unit25	BATCH
4100718	Corner bead 1007 1.80running metres/rail 1batch=45.00running metres Packaging unit25	BATCH
410072	Corner bead 1007 2.00running metres/rail 1batch=50.00running metres Packaging unit25	BATCH
4100722	Corner bead 1007 2.20running metres/rail 1batch=55.00running metres Packaging unit25	BATCH
41007225	Corner bead 1007 2.25running metres/rail 1batch=56.25running metres Packaging unit25	BATCH
4100725	Corner bead 1007 2.50running metres/rail 1batch=62.50running metres Packaging unit25	BATCH
4100726	Corner bead 1007 2.60running metres/rail 1batch=65.00running metres Packaging unit25	BATCH
4100727	Corner bead 1007 2.70running metres/rail 1batch=67.50running metres Packaging unit25	BATCH
41007275	Corner bead 1007 2.75running metres/rail 1batch=68.75running metres Packaging unit25	BATCH
410073	Corner bead 1007 3.00running metres/rail 1batch=75.00running metres Packaging unit25	BATCH

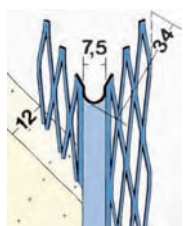

#### Corner bead, 1005 Protektor round nose

Itm.Nr.	Description	Unit
41005	Corner bead 1005 1.5-3running metres, round nose Packaging unit25	RM

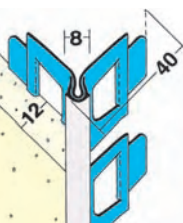

#### Corner bead, 1041 Protektor

Angle bead with cut-off wall angles and PVC-nose for finishing arches and clean edges on spiral staircases.

Itm.Nr.	Description	Unit
41041	Corner bead 1041 2.5running metres Packaging unit15	RM

## Render Beads



### Render bead

Made of galvanised plate steel according to EN 10142 and EN 10143.

Itm.Nr.	Description	Unit
46	Render bead 6mm 2.50running metres Packaging unit125running metres 120batches/pallet	BATCH
410	Render bead 10mm 2.50running metres Packaging unit125running metres 80batches/pallet	BATCH

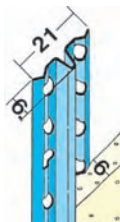

### Render bead Protektor

Basically, plaster and corner profiles in humid rooms need to be integrated in stainless steel. All mortar profiles have to be of the same material as the basic plaster which will be applied later.

Itm.Nr.	Description	Unit
41106	Render bead 1106 6mm, 2.5-3.0running metres Packaging unit50	RM
41105	Render bead 1105 10mm, 2.5-3.0running metres Packaging unit50	RM

## Render Stop Beads - Movement Beads

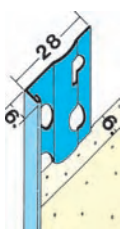

### Render stop bead for interior plastering

Profiles for creating exact render stops made of galvanised sheet steel.

Itm.Nr.	Description	Unit
41216	Render stop bead, expansion joint profile 1216, 6mm, 2.5-3.0running metres Packaging unit25	RM
41211	Render stop bead 1211 9mm, 2.0-4.0running metres Packaging unit25	RM
41212	Render stop bead 1212 10mm, 2.5-3.0running metres Packaging unit25	RM
41218	Render stop bead 1218 12mm, 2.5-4.0running metres Packaging unit25	RM
41210	Render stop bead, expansion joint profile 1210 14mm, 2.0-4.0running metres Packaging unit25	RM
41220	Render stop bead 1220 18mm, 2.5-4.0running metres Packaging unit25	RM

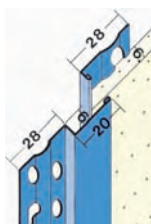

### Render stop bead and expansion joint profile

Profile combinations for creating expansion joints.

Itm.Nr.	Description	Unit
41206	Expansion joint profile 1206 6mm, 2.5+3.0running metres Packaging unit25	RM
41216	Render stop bead, expansion joint profile 1216, 6mm, 2.5-3.0running metres Packaging unit25	RM
41201	Expansion joint profile 1201 6mm 2.0-4.0running metres Packaging unit15	RM
41210	Render stop bead, expansion joint profile 1210 14mm, 2.0-4.0running metres Packaging unit25	RM

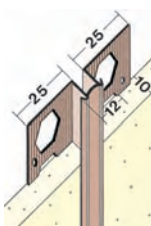

### Movement bead PVC

PVC-movement joint profile with soft-PVC middle section for creating movement joints in the wall or ceiling area.

Itm.Nr.	Description	Unit
43754	Expansion joint profile PVC 3754 2.60running metres Packaging unit34	RM



### Movement bead Combination, interior

For application on straight wall surfaces and in corners up to 90°. The middle section comprises a combination of PVC and TPE. Easy-contact connections possible.

Itm.Nr.	Description	Unit
7531300	Movement bead, interior 10mm 3.00running metres Packaging unit10	RM



## Connecting Profile

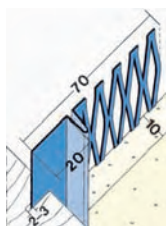

### Architrave bead Protektor

Profiles for creating shadow gaps on internally fitted doorframes and timber etc.

Itm.Nr.	Description	Unit
41306	Architrave bead 1306 10mm 2.1-3.0running metres Packaging unit15	RM
41301	Architrave bead 1301 14mm 2.1-3.0running metres Packaging unit15	RM

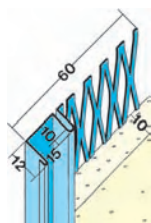

### Architrave bead 1312 Protektor

Bead with existing 15mm wide shadow gap.

Itm.Nr.	Description	Unit
41312	Architrave bead 1312 10mm with shadow gap 2.5+3.0running metres Packaging unit15	RM

## Beads for Exterior Plasters



### Socle Beads - Render Stop Beads

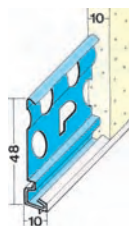

### Socle beads Protektor

Profiles for creating exact render stops/ architraves. Impact resistant PVC-coatings with formed driprnose protect against abrasion and corrosion.

Itm.Nr.	Description	Unit
41227	Socle bead 1227 10mm 2.5+3.0running metres Packaging unit25	RM
41225	Socle bead 1225 14mm 2.5+3.0+4.0running metres Packaging unit25	RM
41229	Socle bead 1229 20mm 2.5+3.0+4.0running metres Packaging unit25	RM
41263	Socle bead 1263 30mm 3.0running metres Packaging unit15	RM
41264	Socle bead 1264 40mm 3.0running metres Packaging unit15	RM
41265	Socle bead 1265 50mm 3.0running metres Packaging unit15	RM
41266	Socle bead 1266 60mm 3.0running metres Packaging unit15	RM

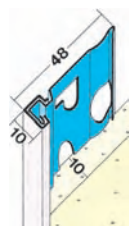

### Render stop beads Protektor

Profiles for creating exact render stops/ architraves.

Itm.Nr.	Description	Unit
41224	Render stop bead 1224 10mm 2.5+3.0running metres Packaging unit25	RM
41223	Render stop bead 1223 14mm 2.5+3.0+4.0running metres Packaging unit25	RM
41222	Render stop bead 1222 20mm 2.5+3.0+4.0running metres Packaging unit25	RM

### Render Stop Beads

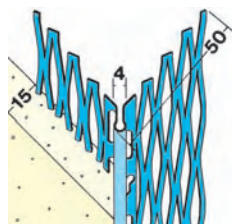

### Angle bead, external Protektor

Angle profiles with increased zinc coating to be completely embedded in the base render.

Itm.Nr.	Description	Unit
41043	Angle bead, external 1043 90° 2.5-3.0running metres Packaging unit15	RM
41044	Angle bead, external 1044 135° 2.5-3.0running metres Packaging unit15	RM

## Reinforced Mesh, Mortar Profiles, EIFS Plugs

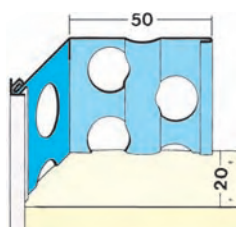

### Angle Bead, external Protektor

For various plaster thicknesses, out of galvanised sheet steel.

Itm.Nr.	Description	Unit
41062	Angle bead, external 1062 20mm 2.5-3.0running metres Packaging unit15	RM
41063	Angle bead, external 1063 30mm 3.0running metres Packaging unit15	RM
41064	Angle bead, external 1064 40mm 3.0running metres Packaging unit15	RM
41065	Angle bead, external 1065 50mm 3.0running metres Packaging unit15	RM
41066	Angle bead, external 1066 60mm 3.0running metres Packaging unit15	RM

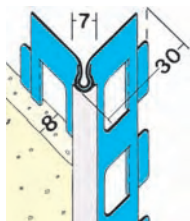

### Angle Bead, external Protektor

Angle profiles for plaster thicknesses of 8mm or 10mm especially for the plastering of porous concrete.

Itm.Nr.	Description	Unit
41023	Angle bead, external 1023 8mm 2.0-3.0running metres Packaging unit15	RM
41020	Angle bead, external 1020 10mm 2.0-3.0running metres Packaging unit15	RM
41013	Angle bead, external 1013 14mm 2.0-3.0running metres Packaging unit15	RM
41014	Angle bead, external 1014 20mm 2.0-3.0running metres Packaging unit15	RM

## Movement Beads

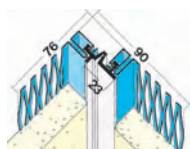

### Expansion joint profile / corner configuration Protektor

Expansion joint profiles made of galvanised sheet steel with elasticated middle section in two widths for absorbing construction expansion joints in the plaster surface.

Itm.Nr.	Description	Unit
43212	Expansion joint profile/corner configuration 3212 10mm 3.0running metres Packaging unit5	RM
43220	Expansion joint profile/corner configuration 3220 20mm 3.0running metres Packaging unit5	RM

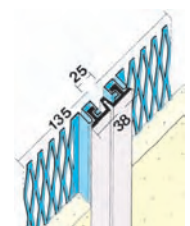

### Expansion joint profile / surface Protektor

Made of galvanised sheet steel

Itm.Nr.	Description	Unit
43200	Expansion joint profile/surface 3200 10mm 3.0running metres Packaging unit5	RM
43204	Expansion joint profile/surface 3204 15mm 3.0running metres Packaging unit5	RM
43208	Expansion joint profile/surface 3208 20mm 3.0running metres Packaging unit5	RM



### Movement bead combination, external

For application on straight wall surfaces and in corners up to 90°. The side parts are made of galvanised steel sheets or stainless steel. Plaster thickness 15mm, can be selected to 20mm. Easy-contact connections possible.

Itm.Nr.	Description	Unit
3236300	Expansion joint profile combination, exterior, variable 15 or 20mm 3.00running metres Packaging unit5	RM

## Ventilation Profiles for Roofs



### Ventilation profiles for roofs Protektor

Stop bead made of galvanised sheet steel fitted against the roof formwork between the eaves for DIN-compatible roof ventilation.

Itm.Nr.	Description	Unit
41241	Ventilation profile for roofs 1241 13mm 2.5running metres Packaging unit20	RM
41242	Ventilation profile for roofs 1242 23mm 2.5running metres Packaging unit10/20 rails	RM

## Widra and Laths



### Widra® wire mesh

Wire mesh for constructive plaster reinforcing fabrics! Saves time and money, because there is no need for wooden slats to be mounted and the undercoat mortar on the angle bead can therefore be quickly and precisely removed. Profitability due to fast handling of Widra wire profile with pure mineral application mortar. The embedding of the whole wire profile in base render results in good corner reinforcement and stable edging! The construction of the wire mesh allows it to be completely filled with render mortar thus preventing hollows in plaster applications.

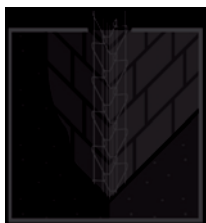

#### Widra® APS/APE

Especially for external areas. A wider longitudinal opening is formed in the corner by cutting-off two longitudinal wires. This therefore guarantees that there is no demixing even in proportionately coarser aggregates. Available in galvanised (APS) and stainless steel version (APE). Packaging unit 40 items = 118 running metres/box.

Itm.Nr.	Description	Unit
7013	Widra APS 2.95running metres/rail, galvanised Packaging unit40=118running metres/box	BOX
7011	Widra APE 2.95running metres/rail, stainless steel Packaging unit40=118running metres/box	BOX



#### Widra® APR

The wire profile for perfectly finished round exterior corners. Galvanised, packaging unit 40 items = 118 running metres/box.

Itm.Nr.	Description	Unit
7016	Widra APR for perfectly finished round corners 2.951fm/rail galvanised Packaging unit40	RAIL



#### Widra® APA

For window and door openings in outside facades Galvanised, packaging unit 40 items = 118 running metres/box.

Itm.Nr.	Description	Unit
7014	Widra APA 2.95running metres/rail, galvanised Packaging unit40=118running metres/box	BOX



#### Widra® AP

Allows for horizontal and vertical screeding of mineral undercoat mortar on the corners of outside walls and provides good corner reinforcement. Galvanised, packaging unit 40 items = 118 running metres/box.

Itm.Nr.	Description	Unit
38903	Widra AP 2.95running metres/rail, galvanised Packaging unit40=118running metres/box	BOX

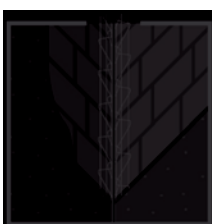

#### Widra® APK

Especially for plastering facades where an impact resistant, plastic-coated nosing is required to prevent demolition and corrosion. Galvanised with plastic nosing, available in white and beige. Packaging unit 25 items = 73.75 running metres/box.

Itm.Nr.	Description	Unit
389	Widra APK 2.95running metres/rail, galvanised Packaging unit25	RAIL



#### Widra® APBK

The wire profile with plastic-coated nose for external arches and arched constructions. Galvanised with plastic nosing, available in white and beige. Packaging unit 25 items = 73.75 running metres/box.

Itm.Nr.	Description	Unit
7017	Widra APBK 2.95running metres/rail, galvanised Packaging unit25	RAIL

## Reinforced Mesh, Mortar Profiles, EIFS Plugs



### Widra® APB

The wire profile for external arches and rounded constructions. Galvanised, packaging unit 40 items = 118 running metres/box.

Itm.Nr.	Description	Unit
7018	Widra APB 2.95running metres/rail Packaging unit40	RAIL

### Stucanet®

Stucanet is a lath in panel form made of galvanised welded wire mesh into which an absorbent sheet of perforated chip paper is interwoven. The area of application is modern wet plaster technology in interiors and on facades. The render application is carried out by spraying from mixing pumps or through manual application.

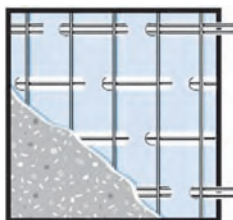

### Stucanet® S

Stucanet S is easy to fix to substructures of wood, steel, concrete or masonry. With 2 parallel wires for fixing. Packaging unit 15 boards = 25 m<sup>2</sup>/ batch, 375 boards = 630 m<sup>2</sup>/pallet.

Itm.Nr.	Description	Unit
3885	Stucanet S 240x70cm 1 panel=1.68m <sup>2</sup> 1 batch=15 panels	PLAT.

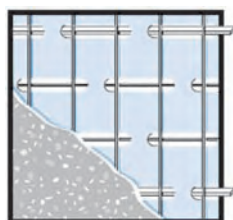

### Stucanet® 80

With parallel wire for fixing. Packaging unit 15 boards = 25 m<sup>2</sup>/ batch, 120 boards = 202 m<sup>2</sup>/pallet.

Itm.Nr.	Description	Unit
3881	Stucanet 80 240x70cm 1 panel=1.68m <sup>2</sup> 1 batch=15 panels	PLAT.

### Armanet®, Armanet® D and Armanet® Iso

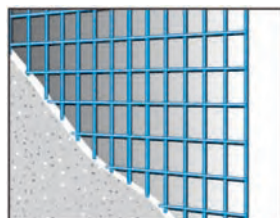

### Armanet®

Armanet is a heavily galvanised welded reinforcing mesh, finely galvanised according to the Bekaert "3 x Zn" procedure with at least 350 g/m<sup>2</sup> zinc coating. Armanet is excellent as a reinforcement for mineral plasters and insulation plasters and is used for the renovation of cracking brickwork inside and out.

Itm.Nr.	Description	Unit
405127	Armanet 12.7x12.7x0.8mm 100cm wide 25running metres/roll	Roll



### Armanet® D (Distanet)

Armanet D (Distanet) rendering mesh panel is welded wire for exterior and interior plaster on diverse surfaces. The wire mesh panel stands out due to regularly distributed indentations, which act like individually distributed spacers and which keep the Armanet D "away" from the surface. Armanet D does not require any special spacers for fixing (recommended: fastening system type DB). Make sure there is sufficient overlapping when in use (at least 50mm on the joints and at least 100mm to neighbouring building parts!). Wire strength: 1.05mm, mesh: 16x16mm, zinc coating: min. 350g/m<sup>2</sup>, bend depth: max. 10mm, bend gap: 100x100mm.

Itm.Nr.	Description	Unit
5803	Distanet 40x200cm 0.8m <sup>2</sup> /sheet 1 batch= 20 sheets	BOARD
5804	Distanet 60x200cm 1.2m <sup>2</sup> /sheet 1 batch= 20 sheets	BOARD
5806	Distanet 100x200cm 2.0m <sup>2</sup> /sheet 1 batch= 20 sheets	BOARD

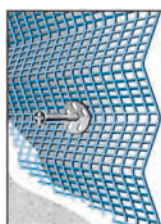

### Armanet® Iso (Welnet)

Armanet Iso (Welnet) is a welded, finely galvanised wire mesh which acts as an insulation plaster carrying support and reinforcement due to its design. Armanet is fixed to the existing plaster base. No pre-treatments of the plaster base is required. And you do not need to remove paint or loose plaster either. Fix the ripple horizontally to the plaster base with the horizontal border wire facing outwards. At least 8 plugs per m<sup>2</sup> should usually be used. Minimum plaster coverage 20 mm. Wire thickness 1.05mm, mesh 16x16mm, panel size 210x99.2cm, zinc coating at least 350g/m<sup>2</sup>. Packaging unit 20 panels/batch, 400 boards/pallet.

Itm.Nr.	Description	Unit
102890	Armanet-Iso (Welnet) 100x210cm 1 sheet=2.1m <sup>2</sup> Packaging unit=20 sheets/batch	BOARD

## Reinforced Mesh, Mortar Profiles, EIFS Plugs

### Riblath

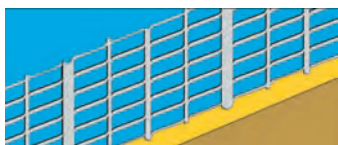

#### Riblath

Riblath made of galvanised sheet steel as mortar support on unstable surfaces, for closing tube slots, joints etc. - lath for a wide range of applications.

Itm.Nr.	Description	Unit
329900	Riblath 1.50m <sup>2</sup> /sheetPackaging unit20	BOARD

## Profiles for EIF-Systems

### Corner Bead EIFS

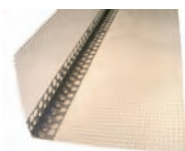

#### Aluminium angle bead with full thermal insulation system mesh

Itm.Nr.	Description	Unit
4040	Aluminium corner profile with full thermal insulation mesh 10x15cm 2.50running metres/rail Packaging unit100	RAIL

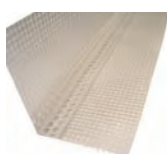

#### PVC-angle with full thermal insulation mesh

Plastic profile with laminated full thermal insulation mesh for the protection of corners and as an aligning aid for the clean formation of building corners.

Itm.Nr.	Description	Unit
4041	PVC corner profile with full thermal insulation mesh 10x15cm 2.50running metres/rail Packaging unit100	RAIL
4041080120	PVC corner profile with full thermal insulation mesh 8x12cm 2.50running metres/rail Packaging unit100	RAIL
5533307	PVC angle bead with full thermal insulation system mesh 10x23cm 2.50running metres/rail Packaging unit50	RAIL

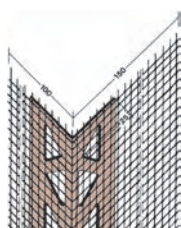

#### Corner bead with mesh, Protektor

with alkali-resistant glass fibre mesh, 10x15cm.

Itm.Nr.	Description	Unit
43707	Corner bead with mesh 3707 10x15cm 2.50running metres/rail Packaging unit50	RM

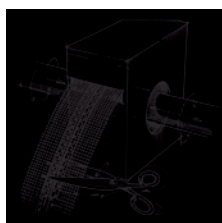

#### PVC corner fix with mesh

This angle mesh is made of rigid punched PVC tape, shock-resistant and break-proof. From its flat shape, it can be shaped into a robust angle bead.

Itm.Nr.	Description	Unit
5901907	PVC corner fix for corners with mesh 10x15cm, punched 50running metres/roll	Roll

### Mesh-covered Driprose EIFS

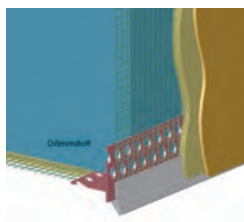

#### Mesh-covered driprose, PVC

Plastic bead with full thermal insulation mesh as render stop bead in recoiling building parts.

Itm.Nr.	Description	Unit
6485302	Mesh-covered driprose, PVC 10x15 2.50running metres/rail Packaging unit20	RAIL



#### Mesh-covered driprose, stainless steel

Clean and precise corner constructions on buildings.

Itm.Nr.	Description	Unit
6481202	Mesh-covered driprose, stainless steel 12.5x12.5 2.0running metres/rail Packaging unit10	Item

## Connecting Profile EIFS

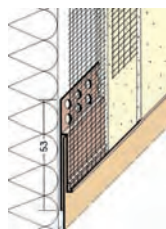

### Connecting profile PVC Protaktor

With alkali-resistant glass fibre mesh specially for fast and technically proper creation of connections to sheet metal flashing in EIFS systems.

Itm.Nr.	Description	Unit
43749	Connecting profile PVC with mesh 2.50running metres/rail Packaging unit20	RM

## Back Ventilation Bead EIFS



### Back ventilation bead Protaktor

The basic coating is aluminium; for assembly on the insulation; ventilation cross section: 207 cm<sup>2</sup>/running metre.

Itm.Nr.	Description	Unit
49224	Back ventilation bead 9224 2.50running metres/rail Packaging unit20	RM

## Render Stop Beads - Movement Bead EIFS



### Movement bead I for EIFS for inner corners (V-shaped)

PVC bead sewn with EIFS-mesh. Polyester yarn with middle section made of rubber.

Itm.Nr.	Description	Unit
4045	Movement bead for EIFS I, inner corner with mesh 2.50running metres/rail Packaging unit25	RAIL



### Movement bead II for EIFS for surfaces (E-shaped)

PVC bead sewn with EIFS-mesh. Polyester yarn with middle section made of rubber.

Itm.Nr.	Description	Unit
4044	Movement bead for EIFS II, straight with mesh 2.50running metres/rail Packaging unit25	RAIL

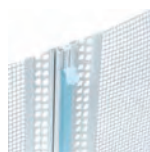

### Movement bead S for EIFS

For application on straight wall surfaces and in corners up to 90°. Middle section is a combination of PVC and TPE. Plaster thickness 6mm. Advantages: - minimum storage, - easy-contact connections possible, - no maintenance of the joint required. Easy-contact connections possible.

Itm.Nr.	Description	Unit
7561300	Movement bead S for EIFS with double-sided mesh 4x4mm 3.0running metres/rail Packaging unit10	RM



### PVC groove bead for EIFS, PVC

For use in EIFS-systems for lining and for the stabilising of insulating wall panels. Good clawing of reinforced mortar due to lateral punching. The groove bead is a fast and perfect opportunity of lining specified insulating wall panels.

Itm.Nr.	Description	Unit
4940304	PVC groove bead for EIFS 2.50running metres/rail Packaging unit20	RAIL

## Socle Beads WDVS

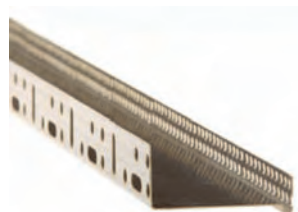

### Box-shaped render profile for surfaces, aluminium

Box-shaped render profiles for EIFS systems, suitable for various insulation thicknesses.

Itm.Nr.	Description	Unit
49144D	Socle bead for EIFS, aluminium 40mm 9144 2.50running metres/rail Packaging unit10	RM
49145D	Socle bead for EIFS, aluminium 50mm 9145 2.50running metres/rail Packaging unit10	RM
49146D	Socle bead for EIFS, aluminium 60mm 9146 2.50running metres/rail Packaging unit10	RM
49147D	Socle bead for EIFS, aluminium 70mm 9147 2.50running metres/rail Packaging unit10	RM
49148D	Socle bead for EIFS, aluminium 80mm 9148 2.50running metres/rail Packaging unit10	RM
49149D	Socle bead for EIFS, aluminium 90mm 9149 2.50running metres/rail Packaging unit10	RM
49150D	Socle bead for EIFS, aluminium 100mm 9150 2.50running metres/rail Packaging unit10	RM
49212D	Socle bead for EIFS, aluminium 120mm 9212 2.50running metres/rail Packaging unit4	RM
49213D	Socle bead for EIFS, aluminium 140mm 9214 2.50running metres/rail Packaging unit4	RM

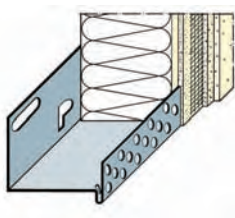

### Box-shaped render profile for surfaces, aluminium, Protektor

Box-shaped render profiles for EIFS systems, suitable for various insulation thicknesses.

Itm.Nr.	Description	Unit
49143	Box-shaped render profile for EIFS, aluminium 30mm 9143 2.50running metres/rail Packaging unit10 for surfaces	RM
49144	Box-shaped render profile for EIFS, aluminium 40mm 9144 2.50running metres/rail Packaging unit10 for surfaces	RM
49145	Box-shaped render profile for EIFS, aluminium 50mm 9145 2.50running metres/rail Packaging unit10 for surfaces	RM
49146	Box-shaped render profile for EIFS, aluminium 60mm 9146 2.50running metres/rail Packaging unit10 for surfaces	RM
49147	Box-shaped render profile for EIFS, aluminium 70mm 9147 2.50running metres/rail Packaging unit10 for surfaces	RM
49148	Box-shaped render profile for EIFS, aluminium 80mm 9148 2.50running metres/rail Packaging unit10 for surfaces	RM
49149	Box-shaped render profile for EIFS, aluminium 90mm 9149 2.50running metres/rail Packaging unit10 for surfaces	RM
49150	Box-shaped render profile for EIFS, aluminium 100mm 9150 2.50running metres/rail Packaging unit10 for surfaces	RM
49212	Box-shaped render profile for EIFS, aluminium 120mm 9212 2.50running metres/rail Packaging unit6 for surfaces	RM
49213	Box-shaped render profile for EIFS, aluminium 140mm 9213 2.50running metres/rail Packaging unit6 for surfaces	RM
49214	Box-shaped render profile for EIFS, aluminium 160mm 9214 2.50running metres/rail Packaging unit6 for surfaces	RM
49216	Box-shaped render profile for EIFS, aluminium 180mm 9216 2.50running metres/rail Packaging unit6 for surfaces	RM
49218	Box-shaped render profile for EIFS, aluminium 200mm 9218 2.50running metres/rail Packaging unit6 for surfaces	RM

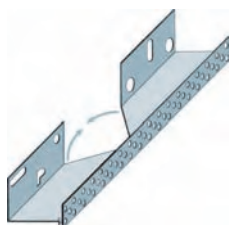

### Box-shaped Render Profiles, aluminium, corner configuration, Protektor

Pre-punched, aluminium box-shaped render profiles for precise formation of corners.

Itm.Nr.	Description	Unit
49283	Box-shaped render profile for EIFS, aluminium 30mm 9283 0.73running metres/rail Packaging unit10, corner construction	Item
49284	Box-shaped render profile for EIFS, aluminium 40mm 9284 0.73running metres/rail Packaging unit10, corner construction	Item
49285	Box-shaped render profile for EIFS, aluminium 50mm 9285 0.73running metres/rail Packaging unit10, corner construction	Item
49286	Box-shaped render profile for EIFS, aluminium 60mm 9286 0.73running metres/rail Packaging unit10, corner construction	Item
49287	Box-shaped render profile for EIFS, aluminium 70mm 9287 0.73running metres/rail Packaging unit10, corner construction	Item
49288	Box-shaped render profile for EIFS, aluminium 80mm 9288 0.73running metres/rail Packaging unit10, corner construction	Item
49289	Box-shaped render profile for EIFS, aluminium 90mm 9289 0.73running metres/rail Packaging unit10, corner construction	Item
49290	Box-shaped render profile for EIFS, aluminium 100mm 9290 0.73running metres/rail Packaging unit10, corner construction	Item
49292	Box-shaped render profile for EIFS, aluminium 120mm 9292 0.73running metres/rail Packaging unit6, corner construction	Item

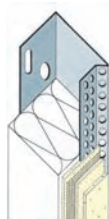

### Stop beads/box-shaped render profiles, aluminium Protektor

Stop beads made of aluminium for EIFS systems, box-shaped, for 8 insulation thicknesses.

Itm.Nr.	Description	Unit
49244	Box-shaped render stop profile for EIFS, aluminium 40mm 9244 2.50running metres/rail Packaging unit10 for surfaces	RM
49245	Box-shaped render stop profile for EIFS, aluminium 50mm 9245 2.50running metres/rail Packaging unit10 for surfaces	RM
49246	Box-shaped render stop profile for EIFS, aluminium 60mm 9246 2.50running metres/rail Packaging unit10 for surfaces	RM
49247	Box-shaped render stop profile for EIFS, aluminium 70mm 9247 2.50running metres/rail Packaging unit10 for surfaces	RM
49248	Box-shaped render stop profile for EIFS, aluminium 80mm 9248 2.50running metres/rail Packaging unit10 for surfaces	RM
49249	Box-shaped render stop profile for EIFS, aluminium 90mm 9249 2.50running metres/rail Packaging unit10 for surfaces	RM
49250	Box-shaped render stop profile for EIFS, aluminium 100mm 9250 2.50running metres/rail Packaging unit10 for surfaces	RM
49252	Box-shaped render stop profile for EIFS, aluminium 120mm 9252 2.50running metres/rail Packaging unit10 for surfaces	RM

## Reinforced Mesh, Mortar Profiles, EIFS Plugs



### Socle bead, Praktika

A plastic profile with nose and dripnose. Can be used independently of the insulation thickness and therefore low storage.

Itm.Nr.	Description	Unit
4039	Socle bead for EIFS Praktika, plastic 2.50running metres/rail Packaging unit25	RAIL

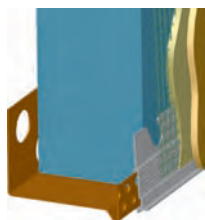

### Clip-on profile, PVC for EIFS - architrave rails

Plastic bead for clean architrave stops. The bead is clipped on to aluminium architrave rails. Potential formation of cracks is prevented due to the possibility of overlapping of the butt-joint of profiles and the special formation of cut-outs. The bead also has a nose and dripnose. The bead is either available in rods or as a roll. The architrave can be formed in one piece when using the rolls.

Itm.Nr.	Description	Unit
8250	Clip-on profile PVC for EIFS architrave rails 2.5 running metres/rail with EIFS mesh	Item

## Beads for Dry Construction Builders

### Angle Bead



### Aluminium angle bead 90°

Made of aluminium, for dry construction.

Itm.Nr.	Description	Unit
4042	Aluminium angle profile, 90° 2.00running metres/rail Packaging unit50	RAIL
40425	Aluminium corner profile, 90° 2.50running metres/rail Packaging unit50	RAIL
40427	Aluminium corner profile, 90° 2.70running metres/rail Packaging unit50	RAIL
404275	Aluminium corner profile, 90° 2.75running metres/rail Packaging unit50	RAIL
4043	Aluminium corner profile, 90° 3.00running metres/rail Packaging unit50	RAIL



### Aluminium angle bead 13x23mm

made of aluminium.

Itm.Nr.	Description	Unit
404125	Aluminium corner profile, 13x23mm 2.50running metres/rail Packaging unit50	BATCH
40413	Aluminium corner profile, 13x23mm 3.00running metres/rail Packaging unit50	BATCH

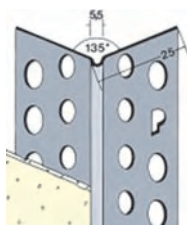

### Aluminium angle bead 135°

made of aluminium.

Itm.Nr.	Description	Unit
40433	Aluminium corner profile, 135° 3.00running metres/rail Packaging unit50	RAIL



### PVC angle bead 25x25mm

Itm.Nr.	Description	Unit
0160307	PVC angle bead 25x25mm 2.5m 125 running metres/batch Packaging unit50	RAIL
0160605	PVC angle bead 25x25mm 3.0m 75 running metres/batch Packaging unit25	RAIL
0160607	PVC angle bead 25x25mm 3.0m 150 running metres/batch Packaging unit50	RAIL

### Casing Bead

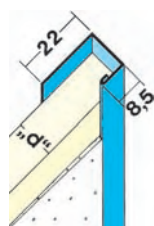

### Casing bead, steel

For dry constructions. Made of galvanised plate steel according to EN 10142 and EN 10143.

Itm.Nr.	Description	Unit
41121250D	Profile 1121 12.5mm 1rail=2.5m casing bead, dry construction, steel Packaging unit25	RAIL
41121300D	Profile 1121 12.5mm 1rail=3.0m casing bead, dry construction, steel Packaging unit25	RAIL
41122250D	Profile 1122 15mm 1rail=2.5m casing bead, dry construction, steel Packaging unit25	RAIL
41122300D	Profile 1122 15mm 1rail=3.0m casing bead, dry construction, steel Packaging unit25	RAIL

## Reinforced Mesh, Mortar Profiles, EIFS Plugs

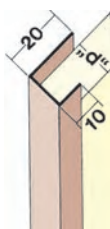

### Casing bead PVC

For dry constructions.

Itm.Nr.	Description	Unit
43741250D	Profile 3741 12.5mm 1rail=2.5m casing bead, dry construction, PVC Packaging unit50	RAIL
43741300D	Profile 3741 12.5mm 1rail=3.0m casing bead, dry construction, PVC Packaging unit50	RAIL
43747250D	Profile 3747 15mm 1rail=2.5m casing bead, dry construction, PVC Packaging unit50	RAIL
43747300D	Profile 3747 15mm 1rail=3.0m casing bead, dry construction, PVC Packaging unit50	RAIL

## Stop Bead Protektor

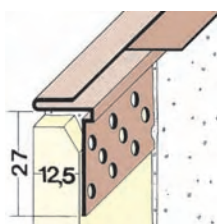

### Stop bead PVC 3766

PVC-stop bead for plasterboard with removable masking strips. The S-shape of the PVC bead creates an elastic connection to adjoining building components (e.g. ceilings).

Itm.Nr.	Description	Unit
43766	Stop bead PVC for insulation render PVC 3766 3.00running metres/rail Packaging unit35	RM

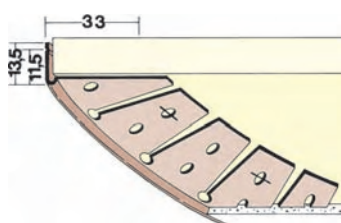

### Stop bead PVC 3768

One-sided cut-off PVC stop bead for creating shadow gaps in ceiling areas on rounded walls. The bead is to be additionally fixed with galvanised brackets in order to hold bead in position.

Itm.Nr.	Description	Unit
43768	Stop bead PVC for insulation render 3768 3.00running metres/rail Packaging unit20	RM

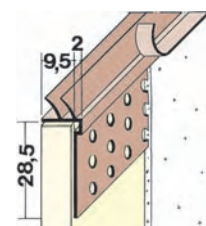

### Stop bead PVC 3784

PVC-stop bead for plasterboard from 9.5mm with sealing lips, made of soft PVC, to provide an elastic connection for adjoining construction parts. Removable protective strip protects adjoining construction parts from being soiled.

Itm.Nr.	Description	Unit
43784	Stop bead PVC for insulation render 3784 3.00running metres/rail Packaging unit30	RM

## Angle Bead Protektor

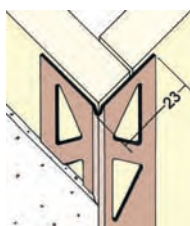

### Angle bead, PVC 3751

Angle bead made of PVC on the roll for smoothing work. With joint: can be used for sharp to blunt edged plasterboard nose.

Itm.Nr.	Description	Unit
43751	Angle bead PVC 3751 50running metres/roll 1box =2rolls	Roll

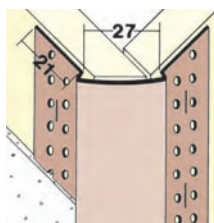

### Angle bead, PVC 3789

One-sided cut-off PVC-angle bead for the creation of rounded plasterboard constructions. Manually bend bead and fully embed.

Itm.Nr.	Description	Unit
43789	Angle bead PVC 3789 3.05running metres/rail Packaging unit30	RM

## Reinforced Mesh, Mortar Profiles, EIFS Plugs



### Angle bead, PVC 3767

One-sided cut-off PVC-angle bead for the creation of rounded plasterboard constructions. Manually bend bead and fully embed.

Itm.Nr.	Description	Unit
43767	Angle bead PVC 3767 3.00running metres/rail Packaging unit20	RM

## Joint Profile Protektor

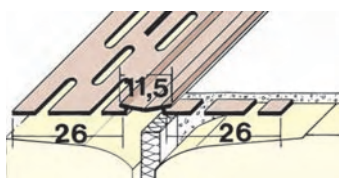

### PVC joint profile 3750

PVC-movement joint profile with soft-PVC middle section for creating movement joints in the wall or ceiling area in accordance with the requirements of DIN 18181.

Itm.Nr.	Description	Unit
43750	PVC joint profile 3750 75running metres/roll	Roll

## Profile Fixings, Connectors and Spacer Tubes

### Profile Fixings



### Nail anchor

For easy fixing of profiles.

Itm.Nr.	Description	Unit
78397	Nail anchor 6x42 ZZ Packaging unit100 (item 93108)	Pg.
78398	Nail anchor 6x55 ZZ Packaging unit100 (item 93109)	Pg.
78401	Nail anchor 8x57 ZZ Packaging unit100 (item 93112)	Pg.
78409	Nail anchor 8x75 ZZ Packaging unit100 (item 93113)	Pg.



### Assembly set for EIFS

For socle beads comprising: 75 nail anchors 6x60mm, 10 bead connectors PV30, 50 levelling pieces AS 3mm.

Itm.Nr.	Description	Unit
1850000030	Assembly set for multi-layer heat insulation for socle beads 75x nail anchors 6x60, 10 bead conn. 30mm, 50 lev. pc.	Item



### Kantenfix Baumit

Mineral quick-drying glue for angle beads and render beads on lime/cement and lime-based plasters, for fixing installations and socle beads.

Itm.Nr.	Description	Unit
3390	Baumit-Kantenfix 30kg/sack Packaging unit54	Sack



### Angle glue, Rapid

Glue for inserting mortar profiles, for fixing electrical and installation lines for interiors and exteriors (with the exception of plasters containing gypsum). Grain size: 0-1 mm Yield: 1 sack is enough for approx. 25 running metres. Mortar profile.

Itm.Nr.	Description	Unit
33901	Rapid angle glue 25kg/sack	Sack

## Reinforced Mesh, Mortar Profiles, EIFS Plugs

### Connectors and Spacer Tubes



#### PVC bead connector

The individual architrave or profile rails are connected to each other by simply joining them together. Allows for quick and easy horizontal and vertical alignment.

Itm.Nr.	Description	Unit
4603039	Bead connectors made of PVC 30mm long Packaging unit100	Pg.
8792115770	PVC bead connector 1.15m-rails for trimming Packaging unit10	RAIL



#### PVC spacer

The levelling pieces are clipped on to the plugs between the support or architrave rail and the old facade surface and secured against loss. For evening out surface unevenness in the facade surface during renovations.

Itm.Nr.	Description	Unit
6075009	Spacer PVC 3mm Packaging unit100	Pg.
6076009	Spacer PVC 5mm Packaging unit100	Pg.
6077009	Spacer PVC 10mm Packaging unit100	Pg.



#### Spacer PVC

One or numerous DAS are inserted one on top of the other in order to even out surface unevenness - DAS's are able to be inserted on top of each other. 2 mm have to be added on when using DAS's inserted one on top of each other for the connector. The element is then simply inserted between the rail for fixing and the plug. Assembly tip: 2 mm have to be added on to the nominal size for the connector when using one DAD or numerous DAD's inserted one on top of each other! Only the overall thickness of the DAD element has to be added to the utilisation length of the plug.

Itm.Nr.	Description	Unit
08660	Spacer disk DAD 1mm nominal size / 3mm overall thickness, white, Packaging unit100	BOX
08661	Spacer disk DAD 4mm nominal size / 6mm overall thickness, grey, Packaging unit100	BOX
08662	Spacer disk DAD 6mm nominal size / 8mm overall thickness, blue, Packaging unit100	BOX
08663	Spacer disk DAD 13mm nominal size / 15mm overall thickness, red, Packaging unit100	BOX

### Plugs

#### Selection of mechanical fixings (plugs)

according to the following criteria:

- Plug classes 0.15 kN or 0.20 kN depending on the classification of the building (see Austrian standards (ÖNORM) B 6400)
- Surface area dowelling
- Dowelling of the peripheral zone
- Surface composition/ Utilisation category
- Thickness of insulation material
- Evaluation of a pull-out test carried out if necessary on the building site

#### Classification of surfaces in utilisation categories

in the following building materials:

##### Utilisation category A

Plastic plugs for use in normal concrete

##### Utilisation category B

Plastic plugs for use in solid bricks

##### Utilisation category C

Plastic plugs for use in hollow or perforated bricks

##### Utilisation category D

Plastic plugs for use in no-fines lightweight concrete

##### Utilisation category E

Plastic plugs for use in porous concrete

## Reinforced Mesh, Mortar Profiles, EIFS Plugs



### EIFS insulation support with mandrel

EIFS insulation support made of polypropylene Copo (plug body) and PA GF-reinforced (plastic mandrel) for mechanical fixing on precarious surfaces. Assembly: after forming the drillhole, the plug is inserted into the drillhole through the insulation. Then the plastic mandrel is driven into the plug body with a hammer. Extract powers for concrete 1.00kN, for solid brick 0.96kN, for hollow bricks 0.83kN.

Item	Description Total length in mm	Disc diameter	Drill diameter	Min. drillhole depth	Min. anchoring depth	Max. insulation thickness	Box per pallet	PU [Item]	Unit
80	EIFS dowel plug with mandrel / 70mm	60 mm	10 mm	60 mm	50 mm	20 mm	56	250	BOX
90	EIFS dowel plug with mandrel / 90mm	60 mm	10 mm	60 mm	50 mm	40 mm	56	250	BOX
110	EIFS dowel plug with mandrel / 110mm	60 mm	10 mm	60 mm	50 mm	70 mm	48	250	BOX
140	EIFS dowel plug with mandrel / 140mm	60 mm	10 mm	60 mm	50 mm	90 mm	40	250	BOX
160	EIFS dowel plug with mandrel / 160mm	60 mm	10 mm	60 mm	50 mm	110 mm	40	250	BOX
190	EIFS dowel plug with mandrel / 190mm	60 mm	10 mm	60 mm	50 mm	130 mm	24	250	BOX

### Plugs "Fischer"



### EIFS insulation support DIPK Fischer

Render fixing made of polypropylene with glass fibre reinforced plastic mandrel. On driving in the mandrel, the plug is expanded and is retained in the wall of the drillhole due to its raised profile. Simple and fast drive-in assembly cuts labour time. Shallow anchoring depth reduces drilling expenditure. Integrated driving-in lock to prevent against driving plug too deeply into drillhole.

Item	Description Total length in mm	Disc diameter	Drill diameter	Min. drillhole depth	Min. anchoring depth	fixing thickness	Box per pallet	PU [Item]	Unit
43966	Rendering fixing DIPK 10 / 60mm	50 mm	10 mm	70 mm	30 mm	10 - 30 mm	70	200	BOX
43967	Rendering fixing DIPK 10 / 90mm	50 mm	10 mm	100 mm	30 mm	40 - 60 mm	70	200	BOX
43968	Rendering fixing DIPK 10 / 110mm	50 mm	10 mm	120 mm	30 mm	60 - 80 mm	70	200	BOX
43969	Rendering fixing DIPK 10 / 130mm	50 mm	10 mm	140 mm	30 mm	80 - 100 mm	42	200	BOX
43970	Rendering fixing DIPK 10 / 150mm	50 mm	10 mm	160 mm	30 mm	110 - 120 mm	36	200	BOX
43971	Rendering fixing DIPK 10 / 170mm	50 mm	10 mm	180 mm	30 mm	120 - 140 mm	18	200	BOX
43972	Rendering fixing DIPK 10 / 190mm	50 mm	10 mm	200 mm	30 mm	140 - 160 mm	18	200	BOX



### Nailed-in anchor Thermofix CF Fischer

Constructive EIFS fastener made of high-quality plastic plug body and one insulation fastener disk. The pre-mounted steel nail is galvanised and the plug body expands when the nail is driven in. Special plugs reduce transmission heat. The plug geometry enables safe anchoring in all conventional wall construction materials. Flexible head counteracts stresses due to temperature and therefore prevents damage to the insulation material.

Item	Description Total length in mm	Disc diameter	Drill diameter	Min. drillhole depth	Min. anchoring depth	Max. fixing thickness	Box per pallet	PU [Item]	Unit
92458	Termofix CF 8 / 95mm	60 mm	8 mm	45 mm	35 mm	60 mm	70	100	BOX
92459	Termofix CF 8 / 115mm	60 mm	8 mm	45 mm	35 mm	80 mm	70	100	BOX
92461	Termofix CF 8 / 135mm	60 mm	8 mm	45 mm	35 mm	100 mm	54	100	BOX
92462	Termofix CF 8 / 155mm	60 mm	8 mm	45 mm	35 mm	120 mm	54	100	BOX
92463	Termofix CF 8 / 175mm	60 mm	8 mm	45 mm	35 mm	140 mm	54	100	BOX
92464	Termofix CF 8 / 195mm	60 mm	8 mm	45 mm	35 mm	160 mm	45	100	BOX
92465	Termofix CF 8 / 215mm	60 mm	8 mm	45 mm	35 mm	180 mm	45	100	BOX
92466	Termofix CF 8 / 235mm	60 mm	8 mm	45 mm	35 mm	200 mm	45	100	BOX

## Reinforced Mesh, Mortar Profiles, EIFS Plugs



### Screwed-in anchor Thermofix 6 H Fischer

Plastic screwed-in anchor with galvanised dry wall screw and integrated rotation lock. Flexible head counteracts stresses due to temperature and therefore prevents damage to the insulation material. Rotation lock reduces transmission heat. The screw drive mechanism with standard T25 bits allows for fast and simple mounting.

Item	Description Total length in mm	Disc diameter	Screw length	Min. anchoring depth	Max. fixing thickness	Box per pallet	PU [Item]	Unit
7360	Termofix 6 H / 60mm	60 mm	50 mm	25 mm	35 mm	60	100	BOX
7361	Termofix 6 H / 80mm	60 mm	70 mm	25 mm	55 mm	60	100	BOX
7362	Termofix 6 H / 100mm	60 mm	90 mm	25 mm	75 mm	60	100	BOX
7363	Termofix 6 H / 120mm	60 mm	110 mm	25 mm	95 mm	45	100	BOX
7364	Termofix 6 H / 140mm	60 mm	130 mm	25 mm	115 mm	21	100	BOX
7365	Termofix 6 H / 160mm	60 mm	150 mm	25 mm	135 mm	21	100	BOX
7366	Termofix 6 H / 190mm	60 mm	180 mm	25 mm	165 mm	21	100	BOX
7367	Termofix 6 H / 210mm	60 mm	200 mm	25 mm	185 mm	21	100	BOX
7264	Termofix 6 H / 230mm	60 mm	220 mm	25 mm	205 mm	21	100	BOX
7368	Termofix 6 H / 250mm	60 mm	240 mm	25 mm	225 mm	21	100	BOX
7369	Termofix 6 H / 310mm	60 mm	300 mm	25 mm	285 mm	21	100	BOX



### Nailed-in anchor Termoz 8NZ Fischer

Admissible nailed-in anchor for the assembly of EIFS systems like polystyrene rigid foam boards or insulation boards on concrete and masonry. The plug is anchored by using the hammer to drive in the pre-mounted glass fibre plug. Fast and safe assembly in all conventional wall construction materials (A, B, C und D). Extremely low thermal bridging due to plastic drive-in plug (chi value 0.002 W/K). Tested according to ETA - 03/0019.

Item	Description Total length in mm	Disc diameter	Drill diameter	Min. drillhole depth	Min. anchoring depth	Max. fixing thickness	Box per pallet	PU [Item]	Unit
40007	Termoz 8NZ / 110mm	60 mm	8 mm	45 mm	35 mm	75 mm	60	100	BOX
40009	Termoz 8NZ / 130mm	60 mm	8 mm	45 mm	35 mm	95 mm	60	100	BOX
40010	Termoz 8NZ / 150mm	60 mm	8 mm	45 mm	35 mm	115 mm	42	100	BOX
40011	Termoz 8NZ / 170mm	60 mm	8 mm	45 mm	35 mm	135 mm	42	100	BOX
40012	Termoz 8NZ / 190mm	60 mm	8 mm	45 mm	35 mm	155 mm	42	100	BOX
40013	Termoz 8NZ / 210mm	60 mm	8 mm	45 mm	35 mm	175 mm	42	100	BOX
40014	Termoz 8NZ / 230mm	60 mm	8 mm	45 mm	35 mm	195 mm	42	100	BOX



### Nailed-in anchor Termoz 8N Fischer

Nailed-in anchor for the fast assembly of EIFS systems. The pre-mounted steel nail is galvanised, Deltaseal-coated and expands the expansion plug when driving it into the surface via the additionally pre-mounted drive-in plug. Approved for assembly in concrete and masonry.

Item	Description Total length in mm	Disc diameter	Drill diameter	Min. drillhole depth	Min. anchoring depth	Max. fixing thickness	Box per pallet	PU [Item]	Unit
3851	Termoz 8 N / 270mm	60 mm	8 mm	65 mm	50 mm	220 mm	28	100	BOX
3852	Termoz 8 N / 290mm	60 mm	8 mm	65 mm	50 mm	240 mm	28	100	BOX

## Reinforced Mesh, Mortar Profiles, EIFS Plugs



### Screwed-in anchor Termoz 8UZ Fischer

Admissible screwed-in anchor for the assembly of EIFS systems with polystyrene rigid foam boards or insulation boards on concrete and masonry. The pre-mounted glass fibre screw is inserted without an additional setting tool by turning the expansion element with the screwdriver and therefore anchoring it. Fast and safe assembly in all conventional wall construction materials (A, B, C und D). Tested according to ETA - 02/0019.

Item	Description Total length in mm	Disc diameter	Drill diameter	Min. drillhole depth	Min. anchoring depth	Max. fixing thickness	Box per pallet	PU [Item]	Unit
40015	Termoz 8UZ / 110mm	60 mm	8 mm	45 mm	35 mm	75 mm	60	100	BOX
40016	Termoz 8UZ / 130mm	60 mm	8 mm	45 mm	35 mm	95 mm	35	100	BOX
40017	Termoz 8UZ / 150mm	60 mm	8 mm	45 mm	35 mm	115 mm	35	100	BOX
40018	Termoz 8UZ / 170mm	60 mm	8 mm	45 mm	35 mm	135 mm	35	100	BOX
40019	Termoz 8UZ / 190mm	60 mm	8 mm	45 mm	35 mm	155 mm	35	100	BOX
40020	Termoz 8UZ / 210mm	60 mm	8 mm	45 mm	35 mm	175 mm	24	100	BOX
40021	Termoz 8UZ / 230mm	60 mm	8 mm	45 mm	35 mm	195 mm	24	100	BOX



### EIFS-countersunk anchor Termoz 8SV Fischer

Plug for EIFS systems Can be used during renovations with existing old plaster (insulation at least 80mm) and for insulations without old plaster (insulation at least 100mm). The Termoz 8SV is pressed into the drillhole until the depth stop touches the surface of the insulation during use. The screw is driven into the plug body with a TORX-30 bit. The disk also turns due to the positive locking connection of screw and plug disk. Thus the depth stop penetrates the insulation. The plug disk is driven further into the plug body. The disk begins to enter the insulation, the insulation warps on the disk rim. The plug disk is driven further into the plug body. The disk breaks through the insulation and compacts the insulation. The plug disk is countersunk so deeply into the insulation material until the installation depth marking is flush with the insulation surface. The anchorage point is sealed by an insulation cover.

Item	Description Total length in mm	Disc diameter	Drill diameter	Min. drillhole depth	Min. anchoring depth	Insulation thickness with/without old	Box per pallet	PU [Item]	Unit
46174	Termoz 8 SV / 130mm	60 mm	8 mm	45 mm	35 mm	80 / 100 mm	45	100	BOX
46175	Termoz 8 SV / 150mm	60 mm	8 mm	45 mm	35 mm	100 / 120 mm	45	100	BOX
46176	Termoz 8 SV / 170mm	60 mm	8 mm	45 mm	35 mm	120 / 140 mm	30	100	BOX
46178	Termoz 8 SV / 190mm	60 mm	8 mm	45 mm	35 mm	140 / 160 mm	30	100	BOX
46179	Termoz 8 SV / 210mm	60 mm	8 mm	45 mm	35 mm	160 / 180 mm	20	100	BOX
46180	Termoz 8 SV / 230mm	60 mm	8 mm	45 mm	35 mm	180 / 200 mm	20	100	BOX
46181	Termoz 8 SV / 250mm	60 mm	8 mm	45 mm	35 mm	200 / 220 mm	20	100	BOX

4500 pcs/Pal.



### Torx-Bits FPB Profibit Fischer

Bit for machine-driven serial screw connections made of tough, hard material (strength 58-60 HRC). High degree of stability through modern cold forming technologies. Advantages/benefits: undamaged screw heads also at high torques. Low wear of bit tip through minimum expenditure of energy. Packaging unit 10 items/box

Itm.Nr.	Description	Unit
67701	Torx Bit FPB T30 Profibit 30 mm Packaging unit10	BOX
67702	Torx Bit FPB T40 Profibit 40 mm Packaging unit10	BOX

## Plugs "Ejot"



## Nailed-in anchor Ejot® TID-T

This nailed-in anchor with steel nail provides a secure fixing in concrete and masonry. Fast and reliable assembly. The plastic-coated nail head reduces thermal bridging and independently closes the plug base thus preventing moisture from entering and from concentrations of plaster.

Item	Description Total length in mm	Disc diameter	Drill diameter	Min. drillhole depth	Min. anchoring depth	Insulation thickness new buildings <sup>1)</sup> / old buildings <sup>2)</sup>	Box per pallet	PU [Item]	Unit
8704095260	EJOT® TID-T 8/60 / 095mm	60 mm	8 mm	35 mm	25 mm	60 / 40 mm	30	200	BOX
8704115121	EJOT® TID-T 8/60 / 115mm	60 mm	8 mm	35 mm	25 mm	80 / 60 mm	27	200	BOX
8704135121	EJOT® TID-T 8/60 / 135mm	60 mm	8 mm	35 mm	25 mm	100 / 80 mm	27	200	BOX
8704155121	EJOT® TID-T 8/60 / 155mm	60 mm	8 mm	35 mm	25 mm	120 / 100 mm	18	200	BOX
8704175121	EJOT® TID-T 8/60 / 175mm	60 mm	8 mm	35 mm	25 mm	140 / 120 mm	30	100	BOX
8704195260	EJOT® TID-T 8/60 / 195mm	60 mm	8 mm	35 mm	25 mm	160 / 140 mm	20	100	BOX
8704215260	EJOT® TID-T 8/60 / 215mm	60 mm	8 mm	35 mm	25 mm	180 / 160 mm	20	100	BOX
8704235260	EJOT® TID-T 8/60 / 235mm	60 mm	8 mm	35 mm	25 mm	200 / 180 mm	20	100	BOX
8704255260	EJOT® TID-T 8/60 / 255mm	60 mm	8 mm	35 mm	25 mm	220 / 200 mm	20	100	BOX
8704275260	EJOT® TID-T 8/60 / 275mm	60 mm	8 mm	35 mm	25 mm	240 / 220 mm	20	100	BOX
8704295260	EJOT® TID-T 8/60 / 295mm	60 mm	8 mm	35 mm	25 mm	260 / 240 mm	20	100	BOX

1) 10mm bonding thickness

2) 10mm bonding thickness and 20mm old plaster residue



## Nailed-in anchor Ejot® IDK-T

Constructive nailed-in anchor with coloured plastic nail for longitudinal differentiation. Plug disks are used to additionally fix the insulation boards of a EIFS system, which are fixed to the ground with bonding mortar. The disk is countersunk in the insulation and covered with an insulation cover. This is how plug imprints are prevented. At the same time a smooth and homogenous insulation surface is created. In conventional assembly the plug disk is flush-mounted the insulation surface. Recommended utilisation loads for concrete, bricks and solid sand-lime brick 0.15kN.

Item	Description Total length in mm	Disc diameter	Drill diameter	Min. drillhole depth	Min. anchoring depth	Insulation thickness new buildings <sup>1)</sup> / old buildings <sup>2)</sup>	Box per pallet	PU [Item]	Unit
18546075156	EJOT® IDK-T 8/60 / 075mm	60 mm	8 mm	35 mm	25 mm	40 / - mm	24	200	BOX
18546095156	EJOT® IDK-T 8/60 / 095mm	60 mm	8 mm	35 mm	25 mm	60 / 40 mm	36	200	BOX
18546115156	EJOT® IDK-T 8/60 / 115mm	60 mm	8 mm	35 mm	25 mm	80 / 60 mm	27	200	BOX
18546135156	EJOT® IDK-T 8/60 / 135mm	60 mm	8 mm	35 mm	25 mm	100 / 80 mm	27	200	BOX
18546155156	EJOT® IDK-T 8/60 / 155mm	60 mm	8 mm	35 mm	25 mm	120 / 100 mm	18	200	BOX
18546175156	EJOT® IDK-T 8/60 / 175mm	60 mm	8 mm	35 mm	25 mm	140 / 120 mm	18	200	BOX

1) 10mm bonding thickness

2) 10mm bonding thickness and 20mm old plaster residue



## Universal screwed-in anchor Ejot® STR 8U

Increased application width and reduced range, a plug type for almost all surfaces, same plug length for flush-mounted and countersunk assembly, safety through high characteristic loads.

Item	Description Total length in mm	Disc diameter	Drill diameter	Min. drillhole depth	Min. anchoring depth	Insulation thickness new buildings <sup>1)</sup> / old buildings <sup>2)</sup>	Box per pallet	PU [Item]	Unit
8709115400	ejothem® STR 8U / 115mm	60 mm	8 mm	50 mm	25 mm	80 / - mm	50	100	BOX
8709135400	ejothem® STR 8U / 135mm	60 mm	8 mm	50 mm	25 mm	100 / 80 mm	40	100	BOX
8709155400	ejothem® STR 8U / 155mm	60 mm	8 mm	50 mm	25 mm	120 / 100 mm	40	100	BOX
8709175400	ejothem® STR 8U / 175mm	60 mm	8 mm	50 mm	25 mm	140 / 120 mm	40	100	BOX
8709195400	ejothem® STR 8U / 195mm	60 mm	8 mm	50 mm	25 mm	160 / 140 mm	30	100	BOX
8709215400	ejothem® STR 8U / 215mm	60 mm	8 mm	50 mm	25 mm	180 / 160 mm	30	100	BOX

1) 10mm bonding thickness

2) 10mm bonding thickness and 20mm old plaster residue

## Reinforced Mesh, Mortar Profiles, EIFS Plugs



### Driving element EJOT® STR tool

For assembly of Ejot ejothem STR 8U.

Itm.Nr.	Description	Unit
79151900000	Driving element Ejot STR complete tool	Item



### Universal screwed-in anchor Ejot® SDM-T plus

Can be used for fixing both in solid and perforated bricks. With long expansion zone, especially suitable for difficult surfaces. Also available for extremely great insulation thicknesses.

Item	Description Total length in mm	Disc diameter	Drill diameter	min. drillhole depth	Min. anchoring depth	Insulation thickness new buildings <sup>1)</sup> / old buildings <sup>2)</sup>	Box per pallet	PU [Item]	Unit
8753120260	EJOT® SDM-T plus 8/60 / 120mm	60 mm	8 mm	80 mm	70 mm	40 / - mm	30	100	BOX
8753140260	EJOT® SDM-T plus 8/60 / 140mm	60 mm	8 mm	80 mm	70 mm	60 / 40 mm	30	100	BOX
8753160260	EJOT® SDM-T plus 8/60 / 160mm	60 mm	8 mm	80 mm	70 mm	80 / 60 mm	30	100	BOX
8753180260	EJOT® SDM-T plus 8/60 / 180mm	60 mm	8 mm	80 mm	70 mm	100 / 80 mm	20	100	BOX
8753200260	EJOT® SDM-T plus 8/60 / 200mm	60 mm	8 mm	80 mm	70 mm	120 / 100 mm	20	100	BOX
8753220260	EJOT® SDM-T plus 8/60 / 220mm	60 mm	8 mm	80 mm	70 mm	140 / 120 mm	20	100	BOX
8753240260	EJOT® SDM-T plus 8/60 / 240mm	60 mm	8 mm	80 mm	70 mm	160 / 140 mm	20	100	BOX
8753260260	EJOT® SDM-T plus 8/60 / 260mm	60 mm	8 mm	80 mm	70 mm	180 / 160 mm	20	100	BOX
8753280260	EJOT® SDM-T plus 8/60 / 280mm	60 mm	8 mm	80 mm	70 mm	200 / 180 mm	20	100	BOX
8753300260	EJOT® SDM-T plus 8/60 / 300mm	60 mm	8 mm	80 mm	70 mm	220 / 200 mm	20	100	BOX
8753320260	EJOT® SDM-T plus 8/60 / 320mm	60 mm	8 mm	80 mm	70 mm	240 / 220 mm	16	100	BOX
8753340260	EJOT® SDM-T plus 8/60 / 340mm	60 mm	8 mm	80 mm	70 mm	260 / 240 mm	16	100	BOX
8753380260	EJOT® SDM-T plus 8/60 / 380mm	60 mm	8 mm	80 mm	70 mm	300 / 280 mm	16	100	BOX
8753420260	EJOT® SDM-T plus 8/60 / 420mm	60 mm	8 mm	80 mm	70 mm	340 / 320 mm	16	100	BOX

1) 10mm bonding thickness

2) 10mm bonding thickness and 20mm old plaster residue



### Nailed-in anchor Ejothem® NT U

This nailed-in anchor has European technical approval for 25mm anchorage depth only, for universal use in concrete, solid brick and perforated brick. The shallow anchorage depth minimises the required plug length. And that's all without having to compromise on safety.

Item	Description Total length in mm	Disc diameter	Drill diameter	Min. drillhole depth	Min. anchoring depth	Insulation thickness new buildings <sup>1)</sup> / old buildings <sup>2)</sup>	Box per pallet	PU [Item]	Unit
8796095400	Ejothem® NT U / 95mm	60 mm	8 mm	35 mm	25 mm	60 / 40 mm	50	100	BOX
8796115400	Ejothem® NT U / 115mm	60 mm	8 mm	35 mm	25 mm	80 / 60 mm	50	100	BOX
8796135400	Ejothem® NT U / 135mm	60 mm	8 mm	35 mm	25 mm	100 / 80 mm	40	100	BOX
8796155400	Ejothem® NT U / 155mm	60 mm	8 mm	35 mm	25 mm	120 / 100 mm	40	100	BOX
8796175400	Ejothem® NT U / 175mm	60 mm	8 mm	35 mm	25 mm	140 / 120 mm	30	100	BOX
8796195400	Ejothem® NT U / 195mm	60 mm	8 mm	35 mm	25 mm	160 / 140 mm	30	100	BOX
8796215400	Ejothem® NT U / 215mm	60 mm	8 mm	35 mm	25 mm	180 / 160 mm	30	100	BOX

1) 10mm bonding thickness

2) 10mm bonding thickness and 20mm old plaster residue

## Plugs - Equipment



### Insulation flange DT 60/8

The insulation flanges can be used wherever it is difficult to insert the flange in the insulation due to their flat heads. Secure anchoring in the structure is attained with a combination of the appropriate screws or dowel plugs.

Itm.Nr.	Description	Unit
01680	Insulation flange DT 60/8 Packaging unit100	BOX

## Reinforced Mesh, Mortar Profiles, EIFS Plugs



### Plug disk SBL plus

Additional disks can be added to the plug disks for perfect adaptation to the respective application.

Itm.Nr.	Description	Unit
8716140008	Plug disk SBL plus 140mm Packaging unit100	BOX



### Polystyrene cutter

Made of plastic for cutting into insulation material for the bored and covered installation of 60mm plug disks.

Itm.Nr.	Description	Unit
7003	Polystyrene cutter 70mm, plastic Packaging unit10	Item



### Polystyrene covers

For the covering of already fitted plugs, after a recess has been pre-cut in the insulation material with the EJOT® Polystyrene Cutter.

Itm.Nr.	Description	Unit
7001	Polystyrene cover 70mm Packaging unit200	BAG



### STR cover

For the covering of already fitted STR-plugs after the plug has been bored into the insulation material by means of the EJOT® STR-tool.

Itm.Nr.	Description	Unit
8593000093	STR covers 60 mm Packaging unit100	BOX